

**Use**

The remote control allows the user to set or modify settings on the presence detectors EEK513P/EEK515P and EEK523P and EEK525P  
Each button corresponds to a command.

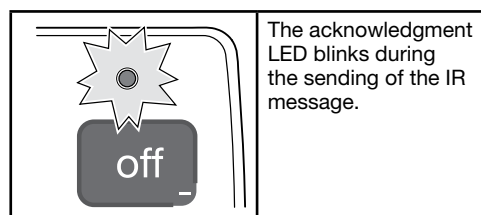

The acknowledgment LED blinks during the sending of the IR message.

**Technical specification**

Power supply: 1x 3V CR2032  
Shelf life of battery: 3½ years  
Protection index: IP 30

**Settings available**

Key	Action	Function	Product Type
on +	Short Press (< 5s.)	On	EEK513P / EEK515P EEK523P / EEK525P
	Long Press (> 5s.)	Dim up	EEK523P / EEK525P
off -	Short Press	Off	EEK513P / EEK515P EEK523P / EEK525P
	Long Press (> 5s.)	Dim down	EEK523P / EEK525P
1	Short Press	To start scene 1	EEK523P / EEK525P
	Long Press (> 5s.)	To start scene 1	
2	Short Press	To start scene 2	
	Long Press (> 5s.)	To start scene 2	
3	Short Press	To start scene 3	
	Long Press (> 5s.)	To start scene 3	
4	Short Press	To start scene 4	
	Long Press (> 5s.)	To start scene 4	